

# Palletizing Gripper ARPG - Bag Gripper Options

Applied Robotics Palletizing Gripper (ARPG) – Bag Gripper provides rapid pick-and-place palletizing of bagged products, offering complete robotic control of a palletizing cell.

## Advantages:

- Flexibility
  - o Options can be used together as one unit or separately, allowing for the same robot to accomplish many tasks.
- Robustness
  - o Engineered construction with select materials provides maximum strength in any industrial environment.

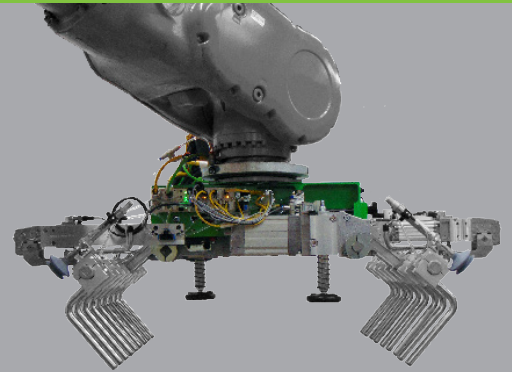

## SPECIFICATIONS

| Option                     | Additional Weight | Operating Pressure | Operating Temperature | Noise Emission (Sound Pressure) |
|----------------------------|-------------------|--------------------|-----------------------|---------------------------------|
|                            | kg (lb)           | bar (psi)          | °C (°F)               | dB (A)                          |
| Pallet Picker              | 2.7<br>(6.0)      | 4 - 6<br>(58 - 87) | 5 - 60<br>(41 - 140)  | ≤ 70 in any direction           |
| Pneumatic Pusher           | 1.0<br>(2.2)      | 4 - 6<br>(58 - 87) | 5 - 60<br>(41 - 140)  | ≤ 70 in any direction           |
| Sheet Picker               | 1.1<br>(2.4)      | 4 - 6<br>(58 - 87) | 5 - 60<br>(41 - 140)  | ≤ 70 in any direction           |
| Servo Bag Width Adjustment | 1.0<br>(2.2)      | 4 - 6<br>(58 - 87) | 5 - 60<br>(41 - 140)  | ≤ 70 in any direction           |

## OPTIONS

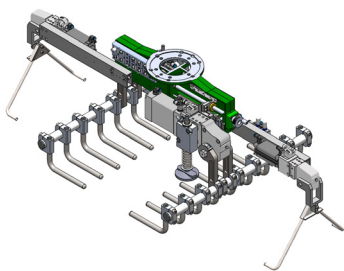

**Pallet Picker**  
Enables picking and placing of standard empty pallets without interrupting palletizing cycle.

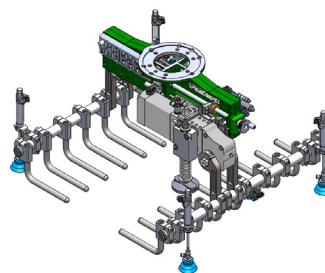

**Sheet Picker**  
Allows picking and placing of any type of sheet via suction cups.

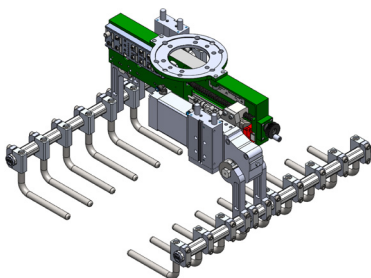

**Pneumatic Pusher**  
Offers controlled clamping and releasing through the use of pneumatic cylinders, as well as giving the same amount of force on all bags, regardless of bag thickness.

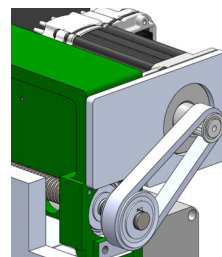

**Servo Bag Width Adjustment**  
Provides on-the-fly bag width adjustment so that multiple bag widths can be palletized without the need for operator intervention.



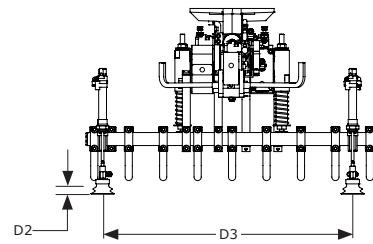
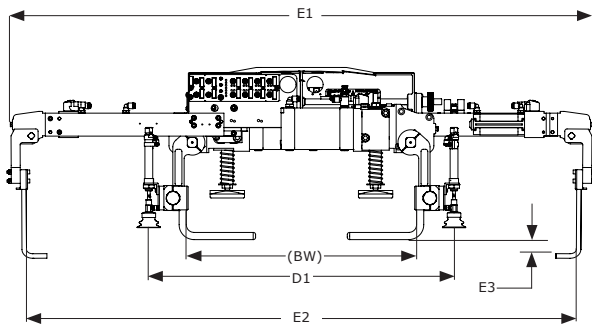
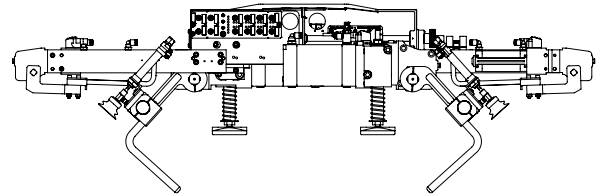
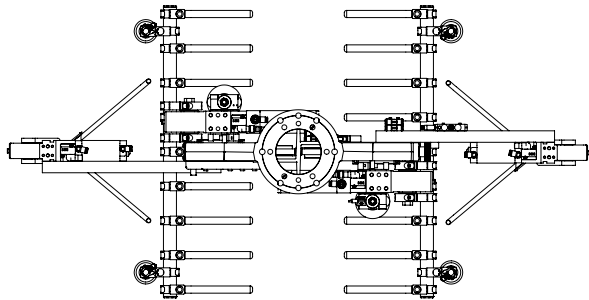

| Model    | Opening Range<br>(Bag Width, BW) |               | Slip Sheet Option  |             |               | Pallet Picker Option |                |                |
|----------|----------------------------------|---------------|--------------------|-------------|---------------|----------------------|----------------|----------------|
|          | B1                               | B2            | D1                 | D2          | D3            | E1                   | E2             | E3             |
| ARPG15   | 200<br>(7.9)                     | 375<br>(14.8) | BW+87<br>(BW+3.42) | 18<br>(0.7) | 381<br>(15.0) | 1288<br>(50.7)       | 1220<br>(48.0) | 37<br>(14.5)   |
| ARPG30   | 300<br>(11.8)                    | 500<br>(19.7) | BW+87<br>(BW+3.42) | 18<br>(0.7) | 534<br>(21.0) | 1288<br>(50.7)       | 1220<br>(48.0) | 37<br>(14.5)   |
| ARPG30-L | 300<br>(11.8)                    | 500<br>(19.7) | BW+87<br>(BW+3.42) | 18<br>(0.7) | 534<br>(21.0) | 1288<br>(50.7)       | 1220<br>(48.0) | 37<br>(14.5)   |
| ARPG50   | 400<br>(15.7)                    | 600<br>(23.6) | BW+87<br>(BW+3.42) | 18<br>(0.7) | 685<br>(29.7) | 1450<br>(57.1)       | 1220<br>(48.0) | 1450<br>(57.1) |
| ARPG50-L | 400<br>(15.7)                    | 600<br>(23.6) | BW+87<br>(BW+3.42) | 18<br>(0.7) | 835<br>(32.9) | 1450<br>(57.1)       | 1220<br>(48.0) | 1450<br>(57.1) |

\* Dimensions are in millimeters (inches).

\*\* All dimensions are descriptive and subject to variation for technical upgrading. We reserve the right to make variations without prior notification.



Applied Robotics  
648 Saratoga Road  
Glenville, NY 12302 USA  
Tel. +1 518 384 1000 Fax +1.5183841200  
info@appliedrobotics.com  
www.appliedrobotics.com



EFFECTO GROUP S.p.A.  
Via Roma, 141/143  
28017 San Maurizio d'Opaglio (NO) - Italy  
Tel. +39 0322 96142 Fax +39 0322 967453  
info@effecto.com  
www.effecto.com

