

XCHANGE™ Utility Module

E31.5 Electrical Modules

Electrical Modules pass signals during an automatic tool changing operation.

Advantages:

- Flexible Connection Options
- Low-Profile to minimize end effector height
- Replacement probes for fast and easy maintenance



SPECIFICATIONS

Model	Description	User Connection	Rated Current	Rated Voltage	Couple/Uncouple Sensor Interface	Weight
			A	V		
E31.5-R-D-PG-10.05-N-00-N	Robot Adaptor – Strain Relief	Strain Relief (4.0 mm – 6.5 mm OD) 10x Max. Wire Gauge: 22 AWG	5 *	Cable Dependent	No	0.02 (0.04)
E31.5-T-D-PG-10.05-N-00-N	Tool Adaptor – Strain Relief	Strain Relief (4.0 mm – 6.5 mm OD) 10x Max. Wire Gauge: 22 AWG	5 *	Cable Dependent	N/A	0.02 (0.04)
E31.5-R-D-PG-10.05-00-N-3.0	Robot Adaptor – Cable	3.0 m (9.8 ft) Pigtail Cable (10x 24 AWG)	5	300	No	0.18 (0.40)
E31.5-T-D-PG-10.05-00-N-1.0	Tool Adaptor – Cable	1.0 m (3.3 ft) Pigtail Cable (10x 24 AWG)	5	300	N/A	0.07 (0.16)

* Rated Current may change based upon cable/wire rating.

Operating Temperature: **5 - 60 °C (40 - 140 °F)**

Noise Emissions (Sound Pressure): **≤ 70 dB(A) in any direction**

CONTACT PROBE TECHNOLOGY

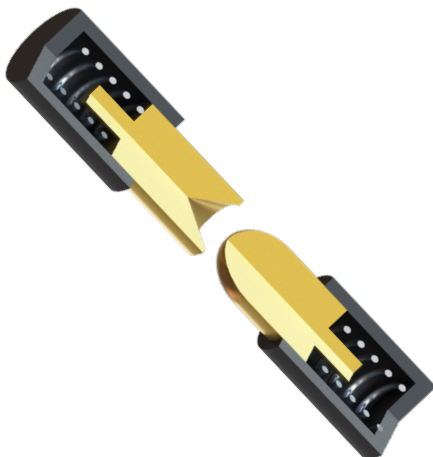

Applied Robotics XCHANGE™ electrical modules use spring loaded contact probes for their many benefits:

- Low contact resistance
- High mating cycles
- Limited debris buildup
- Minimal maintenance

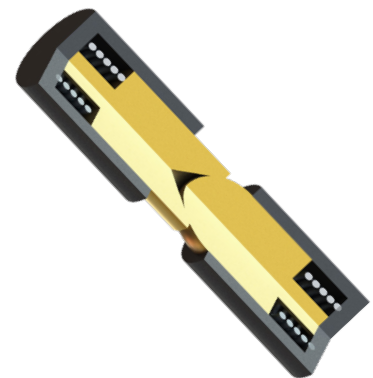

* Images are visual representations only.

PRODUCT INFORMATION

ROBOT ADAPTOR MODULE



TOOL ADAPTOR MODULE

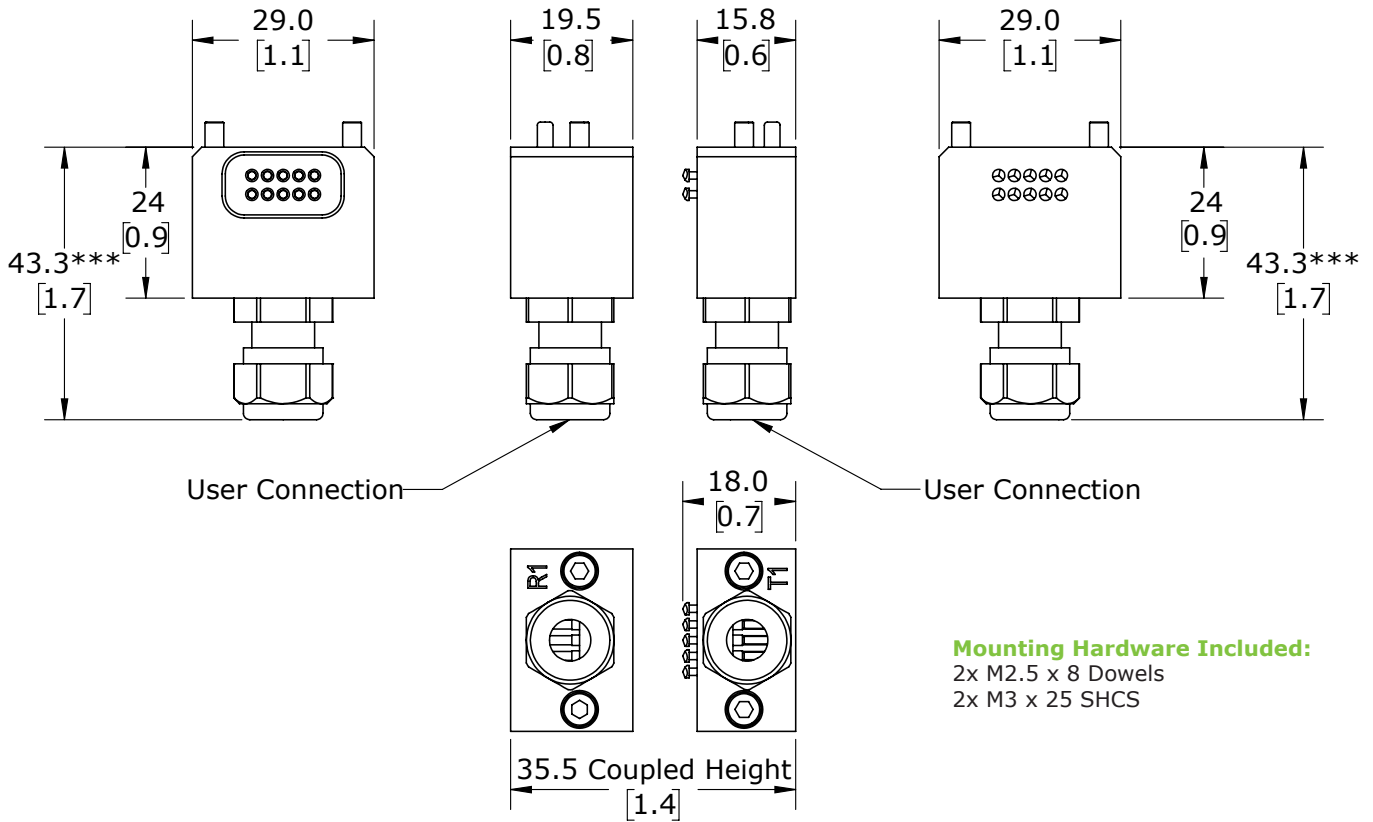

Mounting Hardware Included:

- 2x M2.5 x 8 Dowels
- 2x M3 x 25 SHCS

* Dimensions are in millimeters (inches).

** All dimensions are descriptive and subject to variation for technical upgrading. We reserve the right to make variations without prior notification.

*** Dimension to the end of the Strain Relief. Cable is not included in measurement.



Applied Robotics
648 Saratoga Road
Glenville, NY 12302 USA
Tel. +1 518 384 1000 Fax +1.5183841200
info@appliedrobotics.com
www.appliedrobotics.com



EFFECTO GROUP S.p.A.
Via Roma, 141/143
28017 San Maurizio d'Opaglio (NO) - Italy
Tel. +39 0322 96142 Fax +39 0322 967453
info@effecto.com
www.effecto.com

