

Pneumatic Parallel Grippers

MP-SWIVEL 2-Finger

MP-Swivel is a pneumatic clamping unit that allows the clamping of small components during assembling or light processes. The machining or assembling of parts with several machining axes, with conventional spindles, involves a repositioning of the piece for each side. Swivel fingers (4 positions x 90°) enhances the tool performances by eliminating loss of precision and downtime in the productive cycle. With swivel fingers the complete process is performed with a single loading as the rotation and indexing operations always take place with the vise closed and the piece locked.

Advantages

- Precise wedge-hook mechanism allows machining accuracy
- High force drive for secure clamping
- Optimum jaw guides (hardened, sturdy, low-backlash) allow a longer service life
- Air supply via hose-free direct connections or fitting screw connections

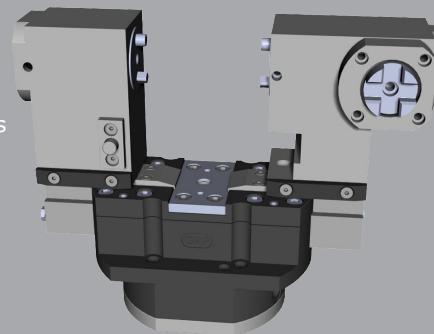

SPECIFICATIONS

Model	Stroke per jaw	Closing force per jaw @ 6 bar	Total closing force @ 6 bar	Pressure	Repeatability	Fluid consumption double stroke	Weight
MP 110 S	12.5 mm 0.49 in	715 N 160.74 lb	1430 N 321.48 lb	6-9 bar 87-130 psi	±0.01 mm ±0.0004 in	125.13 cm ³ 7.64 in ³	8.40 Kg 9.70 lb

Ambient Temperature **5 - 60 °C (41 - 140 °F)**

Noise Emission (Sound Pressure) **≤ 70 dB(A) in any direction or notification.**

SECTIONAL DIAGRAM

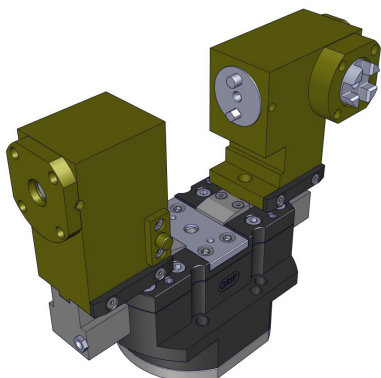

Guidelines for the selection of a gripper model
 Selection of the correct gripper model depends on the workpiece's weight, the friction coefficient between the fingers and the workpiece and the required motion of the application. Due to inertial forces associated with motion, we recommend that the holding force of the gripper model should be from 10 to 20 times the workpiece's weight. If the application presents high acceleration/deceleration or impacts during the motion, then a further safety margin should be considered.

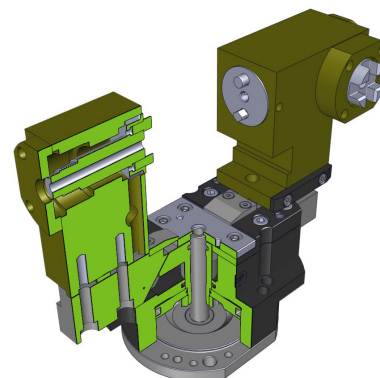

PRODUCT INFORMATION

MP-SWIVEL 2-Finger

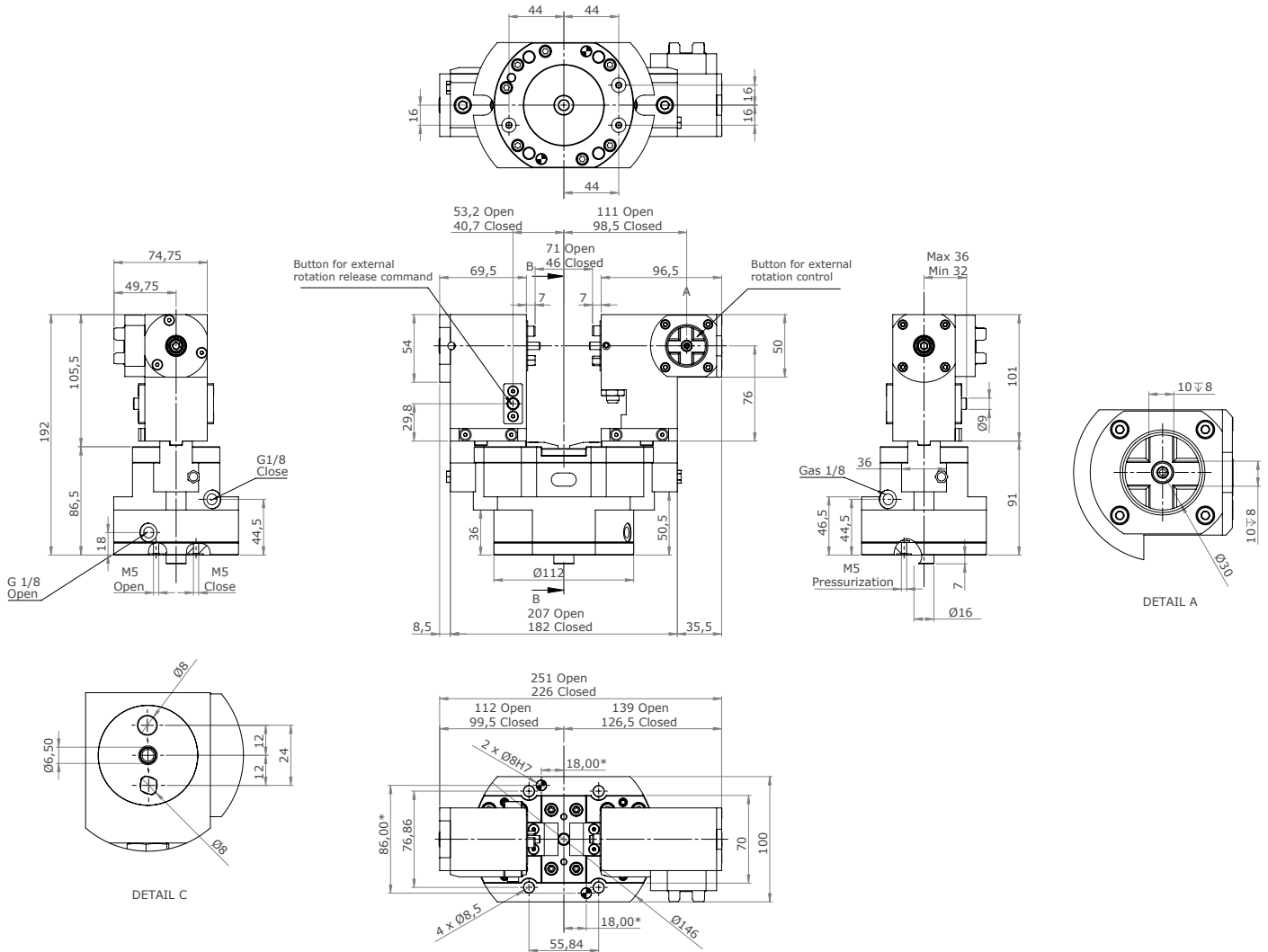

* Dimensions are in millimeters.

** All dimensions are descriptive and subject to variation for technical upgrading. We reserve the right to make variations without prior notification.



Applied Robotics
 A COMPANY OF EFFECTO
 Applied Robotics
 648 Saratoga Road
 Glensville, NY 12302 USA
 Tel. +1 518 384 1000 Fax +1.5183841200
 info@appliedrobotics.com
 www.appliedrobotics.com



EFFECTO GROUP S.p.A.
 Via Roma, 141/143
 28017 San Maurizio d'Opaglio (NO) - Italy
 Tel. +39 0322 96142 Fax +39 0322 967453
 info@effecto.com
 www.effecto.com

