

- Operating temperature : -20°C~90°C
- Offset of angular, parallel, or axial deviation are individual allowed value, so couple reasons of axial offset appearing at same time would reduce the unit allowable value.
- Zero backlash and high precision expansion sleeve design.
- Aluminum sleeve, light and low rotatory inertia.
- Tighted axle to have high friction torque.
- Stable rotation in maximum speed to 40m/s.

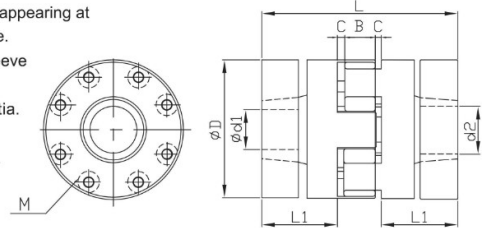

Component	Material	Surface finished	Accessories
Main frame	Aluminum	Anodized	Clamping
Spider	Urethane(PU)	—	

Size		Spider Elastic strength (Color)	Ød1&Ød2 Options * Ød1 ≤ Ød2									L	L1	B	C	Cinch Bolt	
Model	ØD		16	20	24	26	28	29	32	36	38					M	Lock Torque (N-m)
FASE FCSE	55	92sh A(W) 98sh A(R)	●	●	●							78	30	14	2	M5	6
	65					●	●	●	●	●	●	90	35	15	2.5	M5	7
	80					●	●	●	●	●	●	114	45	18	3	M6	12
	95						●	●	●	●	●	126	50	20	3	M8	30

★Moment of inertial torque and weight calculated by maximum diameter.

Specifications		Allowable Torque (N-m)		Allowable Angle Misalignment	Allowable Parallel Misalignment (mm)		Allowable Axile Misalignment (mm)	Static torsional stiffness (N-m/rad)		Max. RPM (r/min ⁻¹)	Moment of inertia (kg-m)	Weight (g)
Model	ØD	R	W		R	W		R	W			
FASE	55	60	35	0.9°	0.1	0.1	1.2	2600	1600	8650	0.78*10 ⁻⁴	162
	65	160	95				1.2	2600	1600	7350	1.70*10 ⁻⁴	240
	80	325	190				1.2	4900	3000	5950	5.17*10 ⁻⁴	490
	95	450	265				1.2	2600	1600	5000	11.7*10 ⁻⁴	772