

FAMB

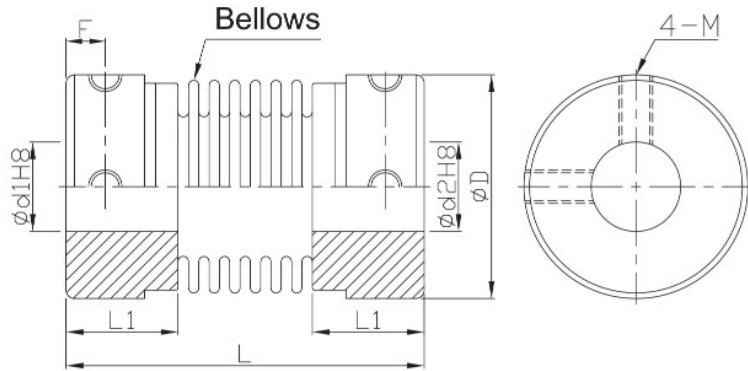

• Offset of angular, parallel, or axial deviation are individual allowed value, so couple reasons of axial offset appearing at same time would reduce the unit allowable value.



*When $\text{Ød1} < 4$ and $\text{Ød2} > 5$, there would be 3 set screws.

*When Ød1 and Ød2 both smaller than 4, there would be 2 set screws.

Component	Material	Surface finish	Accessories
Main frame	Aluminum Alloy	Anodized	Set screw
Bellows	C5191	—	

Dimensions		Ød1&Ød2 selection *Ød1 ≤ Ød2										L	L1	F	Set screw	
Model no.	ØD	3	4	5	6	6.35	8	9.525	10	12	14				M	Lock torque (N·m)
FAMB	12	●	●	●	●	●						23.5	7.5	2.5	2.5	0.5
	16		●	●	●	●	●					26.5	9	3		
	20			●	●	●	●	●	●			32	10	3.5	3	0.7
	25				●	●	●	●	●	●		36.5	12	4.5		
	32				●	●	●	●	●	●	●	42	13.5	5.5		

★ Moment of inertial torque and weight calculated by maximum diameter.

Specification		Allowable wrench torque (N·m)	Allowable misalignment			Static torsional stiffness (N·m/rad)	Max. RPM (r/min ⁻¹)	★ Moment of inertia (kg·m ²)	★ Weight (g)
Model no.	ØD		Angular (°)	Parallel (mm)	Axial (mm)				
FAMB	12	0.3	1.5	0.10	+0.4	82	32000	9.0*10 ⁻⁸	4
	16				-1.2				
	20	0.8	2	0.15	+0.6	180	19000	9.9*10 ⁻⁷	16
	25				-1.8				
	32				-2.5				
		2		0.20	+0.8	330	12000	9.2*10 ⁻⁶	57
				-2.5					

Ordering Example: FAMB20 - 6 - 8 - 100 PCS
 Model no. - Ød1 - Ød2 - Q'ty