

FSMB

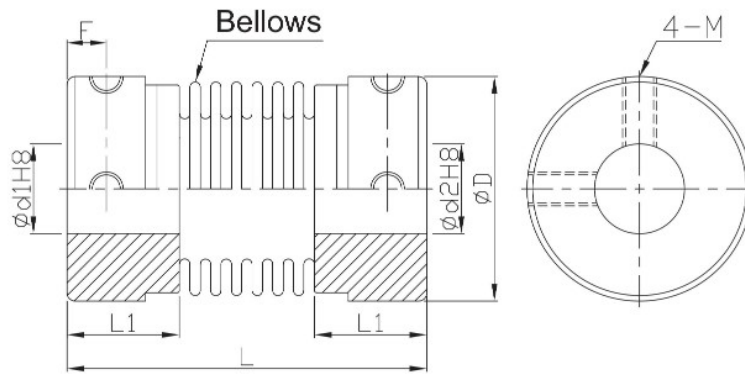

• Offset of angular, parallel, or axial deviation are individual allowed value, so couple reasons of axial offset appearing at same time would reduce the unit allowable value.



*When $\text{Ød1} < 4$ and $\text{Ød2} > 5$, there would be 3 set screws.
 *When Ød1 and Ød2 both smaller than 4, there would be 2 set screws.

Component	Material	Accessories
Main frame	SUS303	Set screw
Bellows	SUS316	

Dimensions		Ød1&Ød2 selection *Ød1 ≤ Ød2										L	L1	F	Set screw	
Model no.	ØD	3	4	5	6	6.35	8	9.525	10	12	14				M	Lock torque (N·m)
FSMB	12	●	●	●	●	●						23.5	7.5	2.5	2.5	0.5
	16		●	●	●	●	●					26.5	9	3		
	20			●	●	●	●	●	●			32	10	3.5	3	0.7
	25				●	●	●	●	●	●		36.5	12	4.5		
	32				●	●	●	●	●	●	●	42	13.5	5.5		

★ Moment of inertial torque and weight calculated by maximum diameter.

Specification		Allowable wrench torque (N·m)	Allowable misalignment			Static torsional stiffness (N·m/rad)	Max. RPM (r/min ⁻¹)	★ Moment of inertia (kg·m ²)	★ Weight (g)
Model no.	ØD		Angular (°)	Parallel (mm)	Axial (mm)				
FSMB	12	0.5	1.5	0.10	+0.4	100	32000	2.1*10 ⁻⁷	9
	16	1			-1.2	150	24000	8.0*10 ⁻⁷	20
	20	1.5	2	0.15	+0.6	220	19000	2.3*10 ⁻⁶	37
	25	2			-1.8	330	15000	7.0*10 ⁻⁶	73
	32	3			+0.8 -2.5	490	12000	2.1*10 ⁻⁵	130

Ordering Example: FAMB25 - 8 - 10 - 100 PCS
 Model no. Ød1 Ød2 Q'ty