

G-MGW050

Technical specifications



Operating mode:

By rotating the semi-cylindrical bolt by 180°, the upper assembly (1) and the lower assembly (2) are braced in a form-closed manner

Advantages:

- Withstands high loads with low dead weight
- Can be released and closed with one handle
- High repeat accuracy +/- 0.02 mm
- Resilient locking pin secures hand lever against independent releasing
- Holds up to 5,000 changing cycles
- During locking, the lower assembly is pulled around the locking stroke
- Interface acc. to DIN EN ISO 9409-1

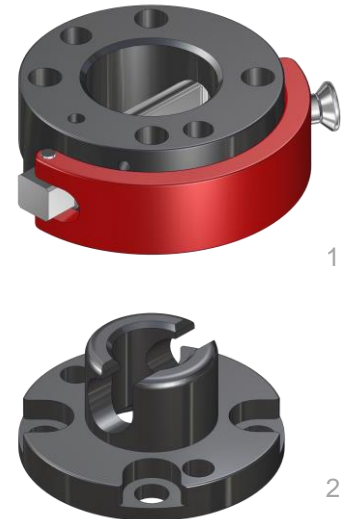

| Technical specifications | | MGW050 | | |
|----------------------------------|----------------|-------------|-------|--------------|
| Basic material | | Al. anod. | VA | St, nitrated |
| External diameter x Height [mm] | | 50 x 30 | | |
| Pitch circle diameter [mm] | | 40 | | |
| Repeat accuracy +/- [mm] | | 0,02 | | |
| Tension Fz [N] | | 700 | 1.100 | 1.320 |
| Compression -Fz [kN] | | 48 | 72 | 96 |
| Torsion Mz [Nm] | | 40 | 60 | 78 |
| Bending Mx, My [Nm] | | 50 | 70 | 80 |
| Mass [kg] | upper assembly | 0,14 | 0,28 | |
| | lower assembly | 0,05 | 0,13 | |
| Recommended load [kg] * | | 10 | 14 | 16 |
| Locking torque VM [Nm] | | 1 - 4 | 2 - 6 | |
| Locking stroke VH [mm] | | 0 - 5 | | |
| Operating temperature range [°C] | | -30 to +120 | | |

* This guideline applies to the following assumptions:
Acceleration: 10 m/s², gravity distance: 100 mm, double safety

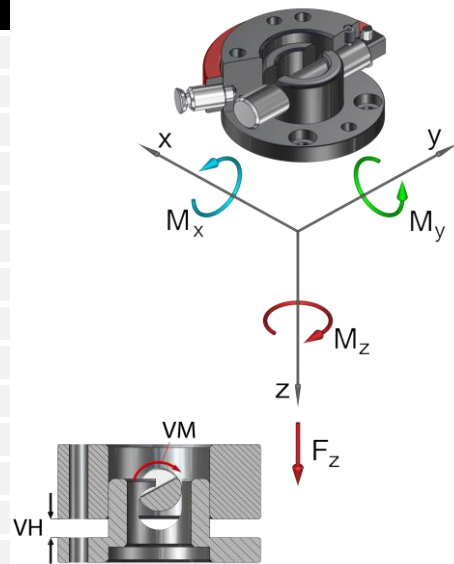

Manual gripper change system Ø50, drilled acc. to ISO...

| | |
|---------------|---------------------------------|
| G-MGW050-2O | upper assembly, Al, anodized |
| G-MGW050-2O-N | upper assembly, steel, nitrated |
| G-MGW050-2O-V | upper assembly, VA |
| G-MGW050-2U | lower assembly, Al, anodized |
| G-MGW050-2U-N | lower assembly, steel, nitrated |
| G-MGW050-2U-V | lower assembly, VA |

Replacement semi-cylindrical bolt...

| | |
|-----------------|------------------------|
| EG-MGW050-HB | for MGW050 |
| EG-MGW050-HB-VA | for MGW050, out off VA |

Replacement hand lever

| | |
|--------------|------------|
| EG-MGW050-HH | for MGW050 |
|--------------|------------|

| Pos. | Description |
|------|-----------------------|
| 1 | Upper assembly |
| 2 | Semi-cylindrical bolt |
| 3 | Hand lever |
| 4 | Index pin |
| 5 | Cylinder bolt |
| 6 | Spring locking pin |
| 7 | Setscrew |
| 8 | Lower assembly |

