



PRODUCT INFO

Swivel clamps LSF.P of glass fiber reinforced polyamide have a fastening lug that is either smooth or with outer crown tootinging.

The fastening lug is centered and situated at an angle of 90° to the flange face.

The flange with bores serves as an interface or for fastening the clamp to the place of use.

The screw point of the fastening lug receives a hex head or hex socket cap screw or a lock nut for fastening any additional parts.

By combining swivel clamps that have identical fastening lugs and corresponding centering ring tootinging, it is possible to assemble any type of joint clamp.

RoHS-compliant product



Original design TCC-PB / TCC-PBF

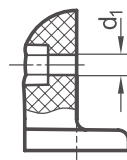
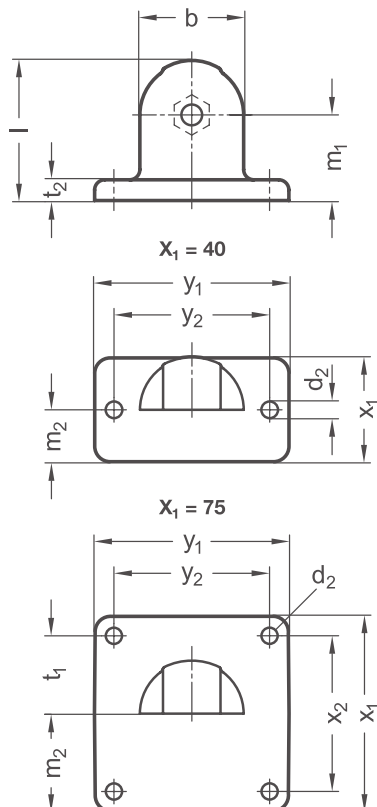

Type OZ

Type AV

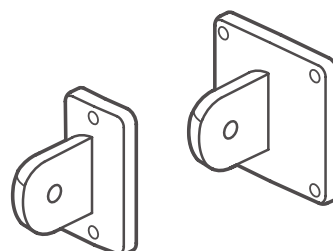
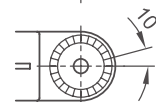
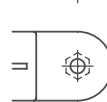
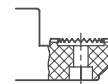
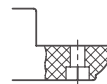

Lug width													
b	x₁	d₁	d₂	Length l	m₁	m₂	t₁	t₂	s	x₂	y₁	y₂	
40	40	8,5	6,5	54	33	20	-	8	13,5	-	75	60	
40	75	8,5	6,5	54	33	37,5	30	8	13,5	60	75	60	

Type t	
OZ	Without centering step (smooth)
AV	With external serration

Surface o	
2	Polyamide (PA), glass fiber reinforced, Black RAL 9005 matt, temperature resistant up to 100 °C
4	Polyamide (PA), glass fiber reinforced, Gray RAL 7040 matt, temperature resistant up to 100 °C

ORDER KEY

LSF.P - b - x₁ - t - o

