

GKT 04 // Telescopic coupling

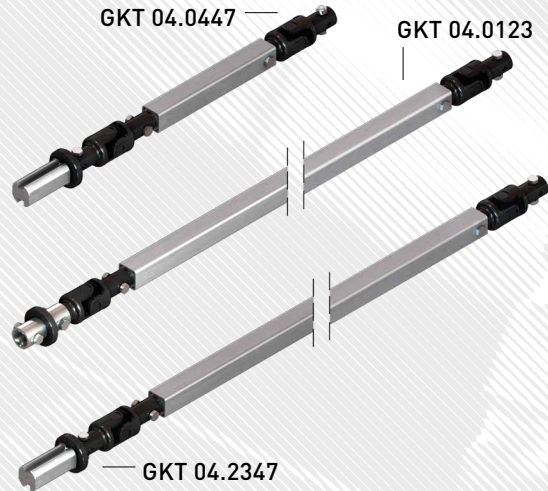

- Telescopic coupling for transmission of drive torques on big VariVent® winding systems.
- For use with variable axial offset between output shaft of power drive/ manual drive and winding shaft.
- Smooth and quiet length adjustment with high-performance rollers, 40 x 40 mm rectangular aluminium tube with 2 steel universal joints, plastic spacer cylinder to assure correct distance away from building.
- Version '32' with external adapter for 32 x 1.5 mm steel winding tube // Version '47' with internal adapter for 50 x 1.5 mm aluminium winding tube.
- All parts stainless, i.e. non-rusting.
- For detailed information about the VariVent® winding systems, please refer to Chapter 2 'Systems'.



GKT 04.2332

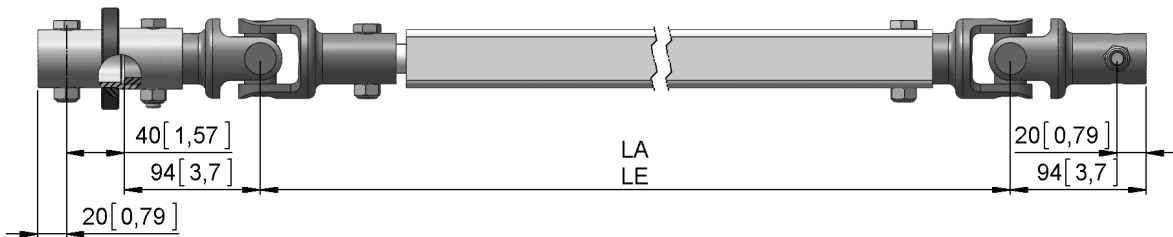

GKT 04.2347

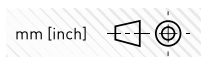
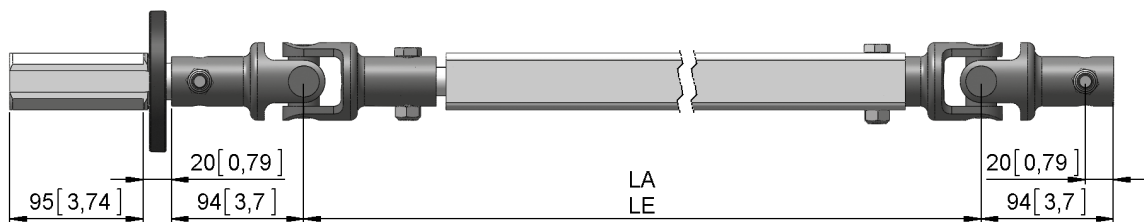

Version	Adapter 32	Adapter 47	HL [m]	LA [mm]	LE [mm]	Tube ø [mm]	m [kg]
	Type no.	Type no.					
GKT 04.2332	20942.0123.32	-	2,30	2000	1550	32 x 1,5	6,0
GKT 04.2732	20942.0127.32	-	2,70	2400	1950	32 x 1,5	6,6
GKT 04.3632	20942.0136.32	-	3,60	2900	2000	32 x 1,5	8,0
GKT 04.0447	-	20942.0104.4721	0,40	485	435	50 x 1,5	3,9
GKT 04.2347	-	20942.0123.4721	2,30	2000	1550	50 x 1,5	6,6
GKT 04.2747	-	20942.0127.4721	2,70	2400	1950	50 x 1,5	6,8