



Dentatura Dritta SERIE 460

Straight tooth system SERIES 460

Q9 - 20MnCr5

Mozzo Corto Short Hub

Qualità - Quality: 9e25

Materiale - Material: 20MnCr5

Angolo di pressione - Pressure angle: 20°

Superficie: finitura di utensile - Surface: milled teeth

Trattamento termico: non incluso

Heat-treatment: not included

R= 1200 N/mm² (resistenza carico a rottura)

R= 1200 N/mm² (tensile strength)

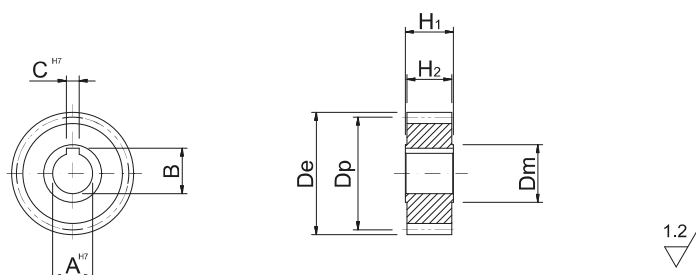

In caso di prodotti personalizzati a disegno, invia la tua richiesta a - In case you need customized products, please send your request to: info@gabinimeccanica.it

CODICE ITEM CODE	M	Z	De	Dp	CH7	B	AH7	H2	H1	Dmh8
1SG19S015016S	1,5	16	27	24	4	11,5	10	28	30	20
1SG19S015018S	1,5	18	30	27	5	17,3	15	28	30	22
1SG19S015020S	1,5	20	33	30	5	17,3	15	28	30	25
1SG19S015024S	1,5	24	39	36	6	22,8	20	28	30	32
1SG19S015030S	1,5	30	48	45	8	28,3	25	28	30	40
1SG19S015040S	1,5	40	63	60	12	43,3	40	28	30	55
1SG19S020016S	2	16	36	32	5	17,3	15	28	30	25
1SG19S020018S	2	18	40	36	5	17,3	15	28	30	30
1SG19S020020S	2	20	44	40	6	22,8	20	28	30	30
1SG19S020022S	2	22	48	44	8	28,3	25	28	30	36
1SG19S020024S	2	24	52	48	8	28,3	25	28	30	36
1SG19S020030S	2	30	64	60	8	28,3	25	28	30	36
1SG19S020040S	2	40	84	80	12	43,3	40	28	30	62
1SG19S030020S	3	20	66	60	6	22,8	20	28	30	30
1SG19S030022S	3	22	72	66	8	28,3	25	28	30	36
1SG19S030024S	3	24	78	72	8	28,3	25	28	30	36
1SG19S030040S	3	40	126	120	12	43,3	40	28	30	62
1SG19S031020S	3,183	20	70,028	63,662	6	22,8	20	28	30	30
1SG19S031022S	3,183	22	76,394	70,028	8	28,3	25	28	30	36
1SG19S031024S	3,183	24	82,76	76,394	8	28,3	25	28	30	36
1SG19S031030S	3,183	30	101,859	95,493	8	28,3	25	28	30	36
1SG19S040020S	4	20	88	80	10	38,3	35	40	50	55
1SG19S040025S	4	25	108	100	10	38,3	35	40	50	55
1SG19S040030S	4	30	128	120	10	38,3	35	40	50	55
1SG19S040032S	4	32	136	128	10	38,3	35	40	50	55
1SG19S050020S	5	20	110	100	14	48,8	45	50	60	68
1SG19S050024S	5	24	130	120	14	48,8	45	50	60	68
1SG19S050025S	5	25	135	125	14	48,8	45	50	60	68
1SG19S050030S	5	30	160	150	14	48,8	45	50	60	68
1SG19S060020S	6	20	132	120	16	59,3	55	60	70	80
1SG19S060021S	6	21	138	126	16	59,3	55	60	70	80
1SG19S060024S	6	24	156	144	16	59,3	55	60	70	80
1SG19S060025S	6	25	162	150	16	59,3	55	60	70	80
1SG19S060030S	6	30	192	180	16	59,3	55	60	70	80
1SG19S080020S	8	20	176	160	20	79,9	75	80	100	110
1SG19S100020S	10	20	220	200	22	90,4	85	100	120	125