

perma STAR VARIO /
perma STAR CONTROL
max. 5 m*



Art. No. 109420



perma NOVA
max. 2 m*



perma FLEX
perma FLEX PLUS
max. 2 m*

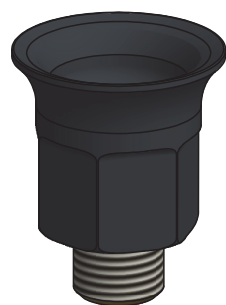

Art. No. 101427

perma FUTURA
perma FUTURA PLUS
max. 1 m*



perma CLASSIC max. 1 m*



Art. No. 104862

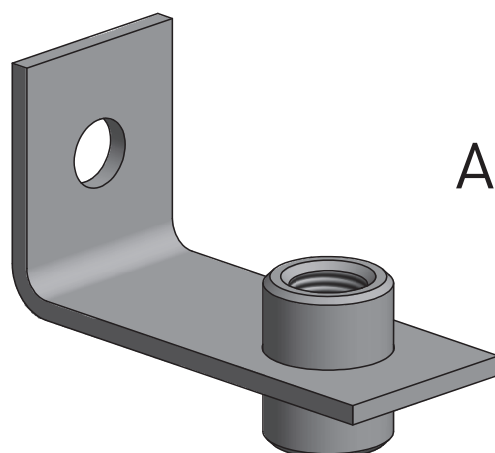

Art. No. 109685

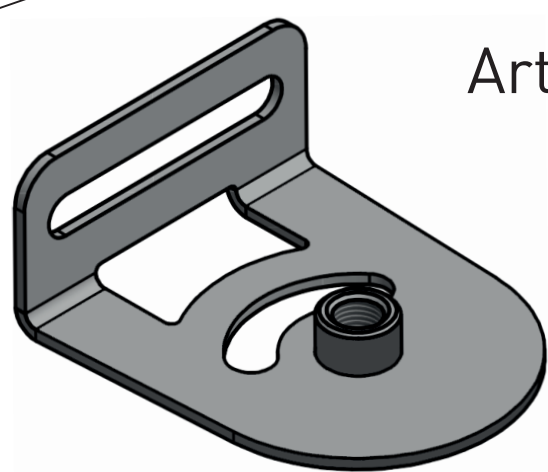

Art. No. 109663

< +80 °C

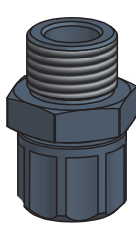

Art. No. 101391

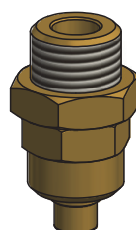

Art. No. 104822

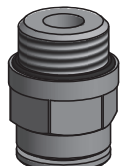

Art. No. 101496

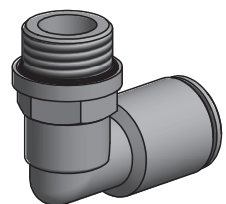

Art. No. 101497



Art. No. 101393

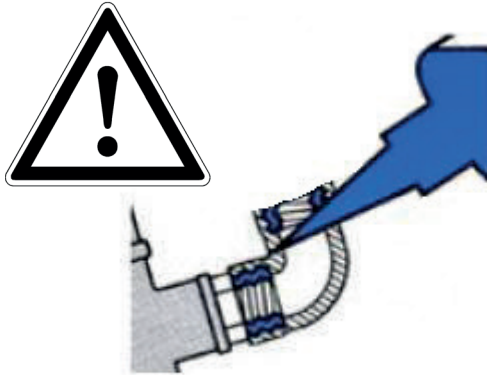

All metal to metal connections must
be glued together with Loctite® 243™
(Art. No. 110278).

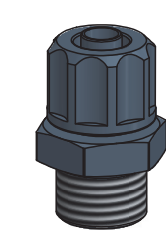

Art. No. 101391

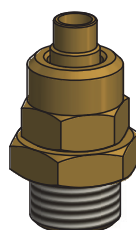

Art. No. 104822

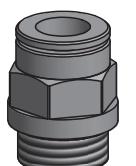

Art. No. 101496

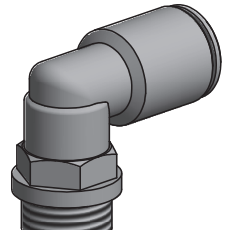

Art. No. 101497

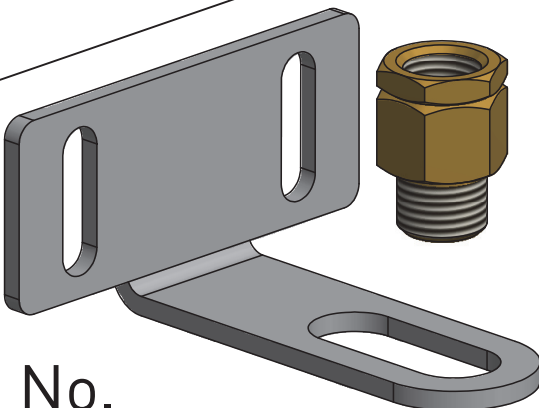

Art. No. 104864

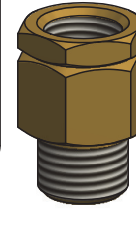

Art. No. 104862

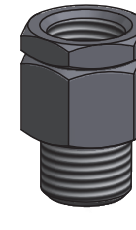

Art. No. 104889

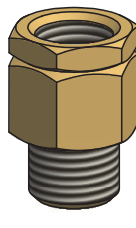

Art. No. 104863

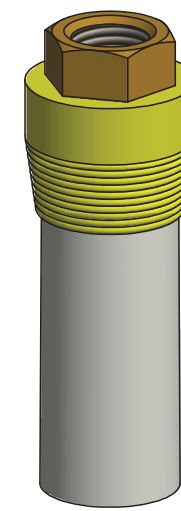

Art. No. 101396

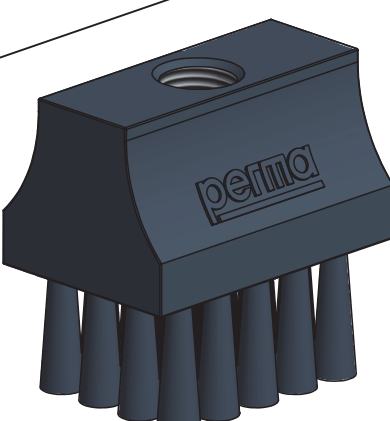

Art. No. 101397

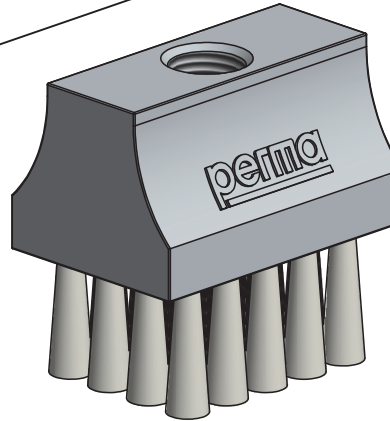

Art. No. 101402

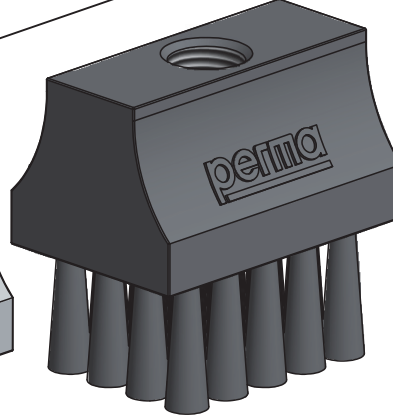

Art. No. 101405

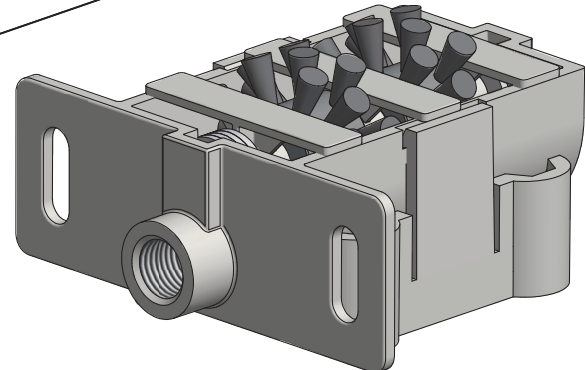

Art. No. 101445

< +260 °C

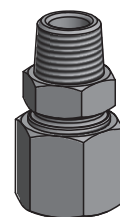

Art. No. 104868

500 mm
Art. No. 113864

1000 mm
Art. No. 101549

1500 mm
Art. No. 101550

Art. No. 104868

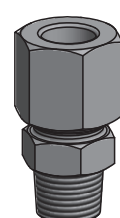

< +100 °C

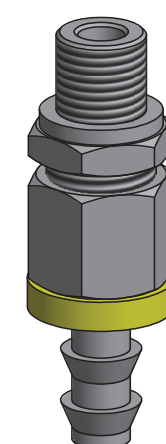

Art. No. 101554



Art. No. 101555

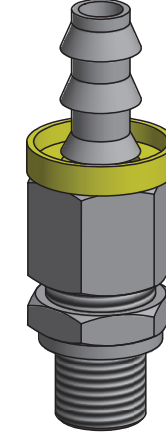

Art. No. 101554

< +260 °C

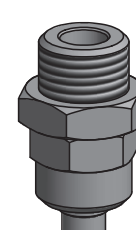

Art. No. 104867



Art. No. 101394

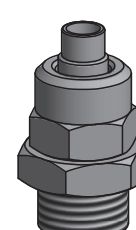

Art. No. 104867

* depending on lubricant and ambient temperature

Support flanges

- 101427 Support flange FLEX G1/4 male x G1/4 female (brass / plastic)
- 109420 Support flange STAR G1/4 male x G1/4 female (brass / plastic)

Mounting Brackets

- 109685 Mounting Bracket CLASSIC, FUTURA, FLEX, NOVA 1-point G1/4 female (stainless steel)
- 109663 Mounting Bracket STAR Standard Duty 1-point G1/4 female (stainless steel)

Tube up +80 °C

- 101393 Tube up to +80 °C oØ 8 mm x iØ 6 mm (PA)
- 101391 Tube connector G1/4 male for tube oØ 8 mm (alu / plastic)
- 104822 Tube connector G1/4 male for tube oØ 8 mm (brass)
- 101496 Tube connector G1/4 male for tube oØ 8 mm straight (brass, nickel-plated)
- 101497 Tube connector G1/4 male for tube oØ 8 mm 90° - rotary type (brass, nickel-plated)

Tube up to +260 °C

- 101394 Tube up to +260 °C oØ 8 mm x iØ 6 mm (PTFE)
- 104867 Tube connector G1/4 male for tube oØ 8 mm (stainless steel)

Heavy Duty hose up to +100 °C

- 101555 Heavy Duty hose up to +100 °C oØ 16 mm x iØ 9.5 mm (with NBR lining and fabric insert)
- 101554 Hose connector G1/4 male for hose iØ 9.5 mm - push-lock (steel, zinc-plated)

Tube up to +260 °C

- 113864 Tube up to +260 °C oØ 11 mm x iØ 8 mm 500 mm (PTFE / stainless steel)
- 101549 Tube up to +260 °C oØ 11 mm x iØ 8 mm 1000 mm (PTFE / stainless steel)
- 101550 Tube up to +260 °C oØ 11 mm x iØ 8 mm 1500 mm (PTFE / stainless steel)
- 104868 Cutting ring coupling R1/4 male for oØ 8 mm straight (stainless steel)

Oil retaining valves

- 104862 Oil retaining valve G1/4 male x G1/4 female up to +60 °C (brass with plastic valve)
- 104889 Oil retaining valve G1/4 male x G1/4 female up to +60 °C (stainless steel with plastic valve)
- 104863 Oil retaining valve G1/4 male x G1/4 female up to +150 °C (brass with metal valve)
- 104864 Bracket (stainless steel)

Oil brushes

- 101396 Oil brush Ø20 mm G1/4 female
- 101397 Oil brush up to +80 °C 40 x 30 mm G1/4 female thread on top
- 101398 Oil brush up to +80 °C 60 x 30 mm G1/4 female thread on top
- 101399 Oil brush up to +80 °C 100 x 30 mm G1/4 female thread on top
- 101411 Oil brush up to +80 °C 40 x 30 mm G1/4 female lateral thread
- 101412 Oil brush up to +80 °C 60 x 30 mm G1/4 female lateral thread
- 101520 Oil brush up to +80 °C 60 x 30 mm G1/4 female thread on top + lateral thread
- 101402 Oil brush up to +180 °C 40 x 30 mm G1/4 female thread on top
- 101403 Oil brush up to +180 °C 60 x 30 mm G1/4 female thread on top
- 101404 Oil brush up to +180 °C 100 x 30 mm G1/4 female thread on top
- 101405 Oil brush up to +350 °C 40 x 30 mm G1/4 female thread on top
- 101406 Oil brush up to +350 °C 60 x 30 mm G1/4 female thread on top
- 101407 Oil brush up to +350 °C 100 x 30 mm G1/4 female thread on top

Chain lubrication box

- 101445 Multipurpose chain lubrication box (plastic)

All metal to metal connections must be glued together with Loctite® 243™ (Art. No. 110278).

For more connecting parts please see our perma catalog at www.perma-tec.com